



Premium Quality, Maintenance Free Bar Stock Ball Valves - Series 76, 86 & 96

2 Otter Court, Raymond, New Hampshire 03077 • Tel. (603) 244-7931 • service@geminivalve.com • www.geminivalve.com

FEATURES

- **Materials of Brass, Carbon Steel, 316 Stainless Steel. 1/2" - 1" 76 Series Alloy 20 & Monel**
- **Self Compensating Valve Stem Seal Design Ensures Long, Leak-Tight Maintenance Free Service**
- **Easily Visible Open / Close Identification**
- **Full Thread Length Compliance with ANSI B1.20.1 Specification**
- **Bubble Tight Closure - each valve is bubble tested to ensure that all sealing points function properly**
- **Pneumatic & Electric Actuators along with a variety of handles Available**



Gemini Valve barstock ball valves are ideal for a wide variety of industrial applications where positive leak-tight service life is required. Unlike most of the commodity quality ball valves in the market place today Gemini Valve continues to manufacture in the USA using the latest precision manufacturing equipment and processes combined with premium quality materials and skilled workmanship.

Manufactured from durable barstock in materials of brass, carbon steel, 316 stainless steel, Alloy 20 & Monel. Body designs include single piece, reduced port, two piece standard and full port.

Valves feature a self-compensating stem seal design which provides exceptional maintenance free service life.

Connections are NPT (National Pipe Taper) female with full thread compliance with ANSI B1.20.1 Specifications. This provides for ease in making up pipe joint connections even with lesser quality pipe threads or fittings. Optional BSPT (British Standard Pipe Taper) and others available upon request.

76 Series features a compact single piece body construction with a reduced port suitable for application where flow is not critical. 86 Series is

the most popular for General Industrial Applications having a standard port construction. For those applications where flow is critical 96 Series full port models may be best suited.

A variety of manual operators are available including lever, stainless steel lever, latching lockable, oval and wing. All secured with a premium locking stem nut to prevent handles from loosening over time while in service.

Valve are manufactured from raw materials in our factory located in Raymond, New Hampshire - USA

Dimensions and Specifications

76 Series

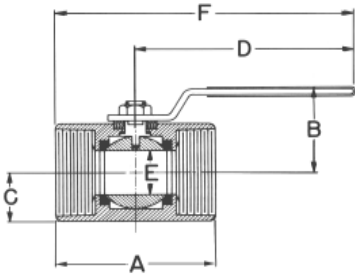

Series	Dimensions - Inches						Dimensions - Millimeters					
	A	B	C	D	E	F	A	B	C	D	E	F
76												
1/2	2.18	1.75	0.50	4.00	0.36	5.09	55.4	44.4	12.7	101.6	9.1	129.3
3/4	2.22	1.80	0.59	4.00	0.49	5.11	56.4	45.7	15.0	101.6	12.4	129.8
1	2.76	2.00	0.75	5.38	0.62	6.76	70.1	50.8	19.0	136.6	15.8	171.7
1-1/4	3.02	2.24	1.00	5.38	0.80	6.87	76.7	57.0	25.4	136.6	20.3	174.5
1-1/2	3.45	2.93	1.06	6.75	0.97	8.35	87.6	74.4	26.9	171.4	24.6	212.1
2	4.04	3.18	1.31	6.75	1.25	8.69	102.6	80.8	33.3	171.4	31.7	220.1

86 / 96 Series

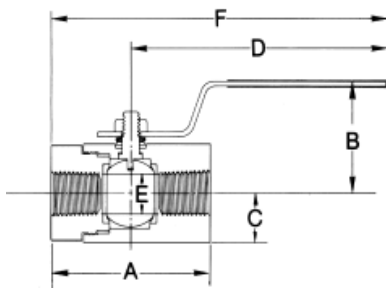

Series		Dimensions - Inches						Dimensions - Millimeters					
		A	B	C	D	E	F	A	B	C	D	E	F
86	96												
1/4 & 3/8	-	2.18	1.75	0.50	4.00	0.36	5.09	56.4	44.4	12.7	101.6	9.1	129.3
1/2	-	2.61	1.84	0.59	4.00	0.49	5.30	66.3	46.7	15.0	101.6	12.4	134.6
3/4	1/2	2.94	2.00	0.75	5.38	0.62	6.85	74.7	50.8	19.0	136.7	15.8	174.0
1	3/4	3.32	2.28	1.00	5.38	0.80	7.04	84.3	58.0	25.4	136.7	20.3	179.0
1-1/4	1	3.70	2.93	1.06	6.75	0.97	8.60	94.0	74.4	26.9	171.4	24.6	218.4
1-1/2	1-1/4	4.25	3.19	1.31	6.75	1.25	8.87	108.0	81.0	33.3	171.4	31.8	225.3
2	1-1/2	4.57	3.37	1.50	6.75	1.50	9.41	116.1	85.6	38.1	171.4	38.1	239.0

Ratings

Pressure:

20 Micron Vacuum to 720 psi (50.62Kg/cm²) C.W.P. (Cold Working Pressure) Non-Shock Service. To 150 psi (10.54Kg/CM²) for Saturated Steam.

Temperature:

-50° F to +450° F (-45° C to +232° C)

Pressure - Temperature Chart

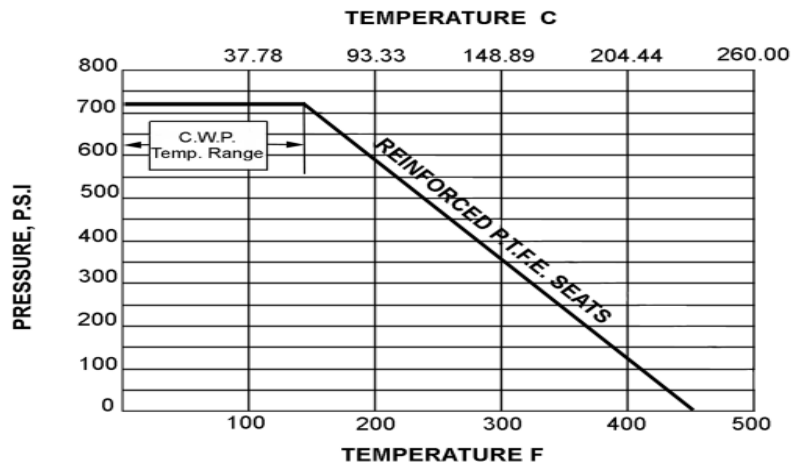

Materials

Brass, Carbon Steel, 316 Stainless Steel. 316 Stainless Steel Ball and Stem Standard. 1/2" - 1" 76 Series available in Alloy 20 & Monel. Consult factory for details.

CAUTION: Care must be taken to assure that the internal media and external environment are compatible with the valve materials.

LIMITED WARRANTY - Copy Available Upon Request.

Specifications subject to change without notice and without obligation on the part of the manufacturer.

Note: A small amount of lubricant is often used in the assembly of the internal components of the valve.



2 Otter Court
Raymond, NH 03077

Tel. (603) 895-4761
FAX (603) 895-6785
www.geminivalve.com

SL06-1711