



1/4" - 2" Bar Stock Ball Valves Tested and Certified by NSF

2 Otter Court, Raymond, New Hampshire 03077 • Tel. (603) 895-4761 • FAX (603) 895-6785

FEATURES

- Special valve and handle configurations to meet your specific application requirements
- Factory direct engineering support
- Bubble-tight closure... every valve is 'bubble-tested' under water to assure the sealing integrity of all sealing elements within each valve
- Made in the U.S.A... we don't miss deliveries because the ship is late. We are a domestic manufacturer that takes pride in delivering quality products on time
- -50°F to 450°F working temperature rating... reinforced P.T.F.E. seals enable the use of our valves in applications from Co2 down to -50°F to hot cooking oil up to 450°F
- Compact design... our bar stock construction offers optimum performance in minimal space



If you manufacture equipment or have applications requiring ball valves tested and Certified by NSF for food oil, water, air, Co2, soft drinks (carbonated & noncarbonated) or syrups, Gemini Valve can meet your needs.

Gemini Valve has serviced many segments of the food equipment industry for over twenty years. Many of our customers' products are Certified by NSF. We offer 1/4" - 2" ball valves that have been tested

and certified to NSF / ANSI 169 Special Purpose Food Equipment and Devices. (formerly NSF / ANSI Criteria C2 - Special Equipment and / or Devices.) We are listed as Components; Ball Valves, Food Zone for the above listed medias. For current models NSF certified please see our listing in the latest 'NSF Listings' publication, online at www.nsf.org or contact us direct.

Need a special valve design? We offer a full service engineer-

ing staff that can custom tailor our products to meet your application requirements.

All of our valves are designed, manufactured and assembled in Raymond, New Hampshire U.S.A. under a Quality Management program.

Don't compromise on such a critical component in your equipment, make sure you specify a valve designed and manufactured by Gemini Valve.

Dimensions and Specifications

76 Series

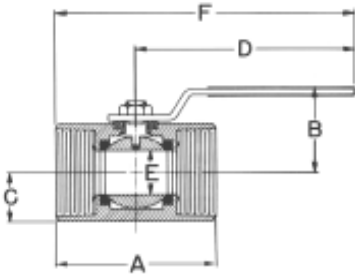

Series	Dimensions - Inches						Dimensions - Millimeters					
	A	B	C	D	E	F	A	B	C	D	E	F
76												
1/2	2.18	1.75	0.50	4.00	0.36	5.09	55.4	44.4	12.7	101.6	9.1	129.3
3/4	2.22	1.80	0.59	4.00	0.49	5.11	56.4	45.7	15.0	101.6	12.4	129.8
1	2.76	2.00	0.75	5.38	0.62	6.76	70.1	50.8	19.0	136.6	15.8	171.7
1-1/4	3.02	2.24	1.00	5.38	0.80	6.87	76.7	57.0	25.4	136.6	20.3	174.5
1-1/2	3.45	2.93	1.06	6.75	0.97	8.35	87.6	74.4	26.9	171.4	24.6	212.1
2	4.04	3.18	1.31	6.75	1.25	8.69	102.6	80.8	33.3	171.4	31.7	220.1

86 / 96 Series

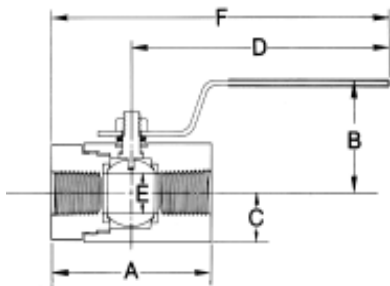

Series	96	Dimensions - Inches						Dimensions - Millimeters					
		A	B	C	D	E	F	A	B	C	D	E	F
86													
1/4 & 3/8	-	2.18	1.75	0.50	4.00	0.36	5.09	56.4	44.4	12.7	101.6	9.1	129.3
1/2	-	2.61	1.84	0.59	4.00	0.49	5.30	66.3	46.7	15.0	101.6	12.4	134.6
3/4	1/2	2.94	2.00	0.75	5.38	0.62	6.85	74.7	50.8	19.0	136.7	15.8	174.0
1	3/4	3.32	2.28	1.00	5.38	0.80	7.04	84.3	58.0	25.4	136.7	20.3	179.0
1-1/4	1	3.70	2.93	1.06	6.75	0.97	8.60	94.0	74.4	26.9	171.4	24.6	218.4
1-1/2	1-1/4	4.25	3.19	1.31	6.75	1.25	8.87	108.0	81.0	33.3	171.4	31.8	225.3
2	1-1/2	4.57	3.37	1.50	6.75	1.50	9.41	116.1	85.6	38.1	171.4	38.1	239.0

Ratings

Pressure:

20 Micron Vacuum to 720 psi (50.62Kg/cm²) C.W.P. (Cold Working Pressure) Non-Shock Service. To 150 psi (10.54Kg/CM²) for Saturated Steam.

Temperature:

-50°F to +450°F (-45°C to +232°C)

Pressure - Temperature Chart

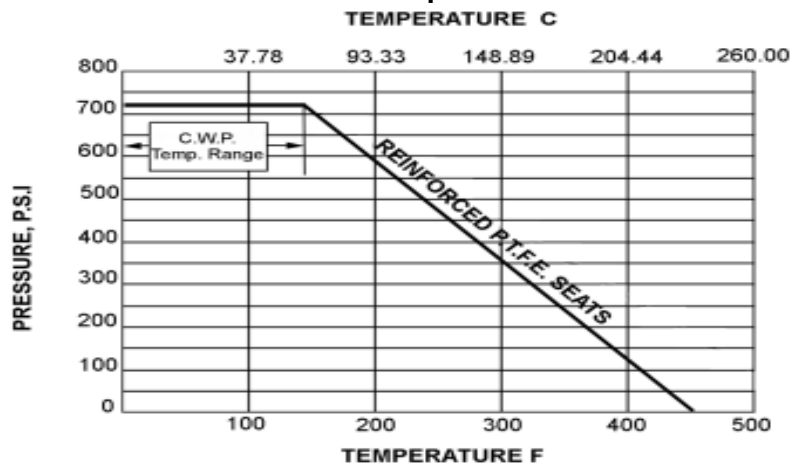

Materials

Carbon Steel and 316 Stainless Steel. 316 Stainless Steel Ball and Stem Standard.

CAUTION: Care must be taken to assure that the internal media and external environment are compatible with the valve materials.



2 Otter Court
Raymond, NH 03077

Tel. (603) 895-4761
FAX (603) 895-6785
www.geminivalve.com

ISL016-0606

LIMITED WARRANTY - Copy Available Upon Request.

Specifications subject to change without notice and without obligation on the part of the manufacturer.

Note: A small amount of lubricant is often used in the assembly of the internal components of the valve.