



1/4" - 2" Premium Quality, Maintenance Free Bar Stock Ball Valves

2 Otter Court, Raymond, New Hampshire 03077 • Tel. (603) 895-4761 • FAX (603) 895-6785 • www.geminivalve.com

FEATURES

- Materials of Brass, Carbon Steel, 316 Stainless Steel. 1/2" - 1" 76 Series Alloy 20 & Monel
- Self Compensating Valve Stem Seal Design Ensures Long, Leak-Tight Maintenance Free Service
- Reinforced P.T.F.E. Seats and Stem Seal
- Easily Visible Open / Close Identification
- Full Thread Length Compliance with ANSI B1.20.1 Specification
- Bubble Tight Closure - each valve is bubble tested to ensure that all sealing points function properly
- BSPT Threads Available
- Pneumatic & Electric Actuators along with a variety of handles Available



Gemini Valve offers three series of bar stock ball valves, 76, 86 & 96 to best meet your application requirements.

If you have found 'cheap' commodity ball valves to be expensive because they don't meet your needs for performance, reliability, and availability, then we can offer you a better value alternative.

As with many simple designs, the subtleties that make the difference are often overlooked by manufacturers of 'commodity' ball valves.

For example, at Gemini Valve, all internal components, including the seats, are precisely machined. This assures bubble tight sealing and optimizes the valve life. It also provides automatic compensation for stem seal wear and thermal expansion and contraction. Every valve is bubble tested to ensure reliable, leak tight performance.

Our 76 Series is a reduced port one piece body, offered in sizes of 1/2" - 2".

Our 86 Series is a standard port

two piece body, offered in sizes of 1/4" - 2". Finally our 96 Series, full port two piece body, is offered in sizes of 1/2" - 1-1/2".

These three series of valves also offer the ideal ball valve for automation by our compact pneumatic actuators and electric actuator provided through our Service Centers. Additionally a variety of manual handles are available. Please see our product literature for details or contact us.

Dimensions and Specifications

76 Series

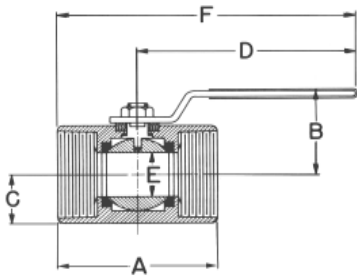

Series	Dimensions - Inches						Dimensions - Millimeters					
	A	B	C	D	E	F	A	B	C	D	E	F
76												
1/2	2.18	1.75	0.50	4.00	0.36	5.09	55.4	44.4	12.7	101.6	9.1	129.3
3/4	2.22	1.80	0.59	4.00	0.49	5.11	56.4	45.7	15.0	101.6	12.4	129.8
1	2.76	2.00	0.75	5.38	0.62	6.76	70.1	50.8	19.0	136.6	15.8	171.7
1-1/4	3.02	2.24	1.00	5.38	0.80	6.87	76.7	57.0	25.4	136.6	20.3	174.5
1-1/2	3.45	2.93	1.06	6.75	0.97	8.35	87.6	74.4	26.9	171.4	24.6	212.1
2	4.04	3.18	1.31	6.75	1.25	8.69	102.6	80.8	33.3	171.4	31.7	220.1

86 / 96 Series

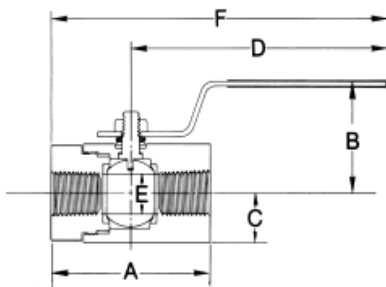

Series		Dimensions - Inches						Dimensions - Millimeters					
		A	B	C	D	E	F	A	B	C	D	E	F
86	96												
1/4 & 3/8	-	2.18	1.75	0.50	4.00	0.36	5.09	56.4	44.4	12.7	101.6	9.1	129.3
1/2	-	2.61	1.84	0.59	4.00	0.49	5.30	66.3	46.7	15.0	101.6	12.4	134.6
3/4	1/2	2.94	2.00	0.75	5.38	0.62	6.85	74.7	50.8	19.0	136.7	15.8	174.0
1	3/4	3.32	2.28	1.00	5.38	0.80	7.04	84.3	58.0	25.4	136.7	20.3	179.0
1-1/4	1	3.70	2.93	1.06	6.75	0.97	8.60	94.0	74.4	26.9	171.4	24.6	218.4
1-1/2	1-1/4	4.25	3.19	1.31	6.75	1.25	8.87	108.0	81.0	33.3	171.4	31.8	225.3
2	1-1/2	4.57	3.37	1.50	6.75	1.50	9.41	116.1	85.6	38.1	171.4	38.1	239.0

Ratings

Pressure:

20 Micron Vacuum to 720 psi (50.62Kg/cm²) C.W.P. (Cold Working Pressure) Non-Shock Service. To 150 psi (10.54Kg/CM²) for Saturated Steam.

Temperature:

-50°F to +450°F (-45°C to +232°C)

Pressure - Temperature Chart

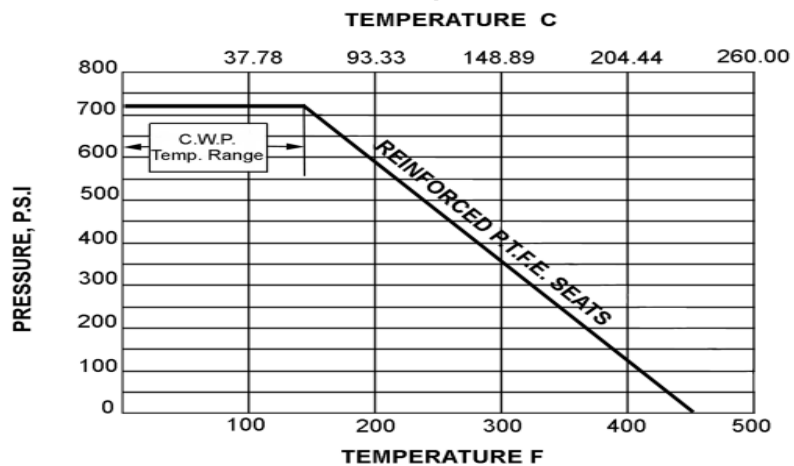

Materials

Brass, Carbon Steel, 316 Stainless Steel. 316 Stainless Steel Ball and Stem Standard. 1/2" - 1" 76 Series available in Alloy 20 & Monel. Consult factory for details.

CAUTION: Care must be taken to assure that the internal media and external environment are compatible with the valve materials.

LIMITED WARRANTY - Copy Available Upon Request.

Specifications subject to change without notice and without obligation on the part of the manufacturer.

Note: A small amount of lubricant is often used in the assembly of the internal components of the valve.



2 Otter Court
Raymond, NH 03077

Tel. (603) 895-4761
FAX (603) 895-6785
www.geminivalve.com

ISL047-0706